

Connector - Channel nut FCN



ADVANTAGES/BENEFITS

- The teeth on the sliding nut provide a secure hold in the FUS rail

APPLICATIONS

- Simple hammer-head nut for installation in FUS rails
- The FCN is suitable for connecting different fixtures and pipe clamps with the mounting rail

PROPERTIES

- Material: steel with min. tensile strength of 415 N/mm²
- Zinc plating: electro zinc plated, min. 5 µm

TECHNICAL DATA



Channel nut FCN

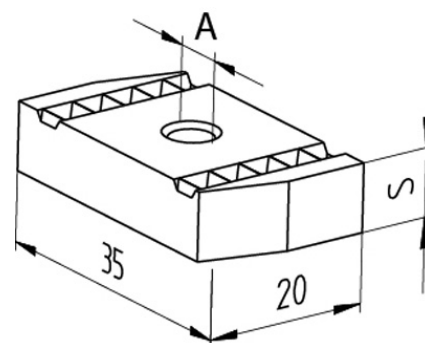

Article name	Art.-No.	Thread A	Thickness S [mm]	Sales unit [pcs]
FCN 6	077405	M 6	6	100
FCN 8	077407	M 8	6	100
FCN 10	077409	M 10	8	100
FCN 12	077411	M 12	9	100

LOADS

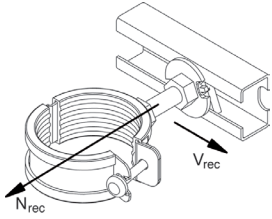

Item	Art.-No.	max. recommended tension load for FUS 2,0 mm N_{rec} [kN]	max. recommended tension load for FUS 2,5 mm N_{rec} [kN]	max. recommended shear load V_{rec} [kN]	Tightening torque for screw grade ≥ 8.8 T_{inst} [kN]
FCN 6	077405	3.0	3.0	1.0	10
FCN 8	077407	4.0	4.0	2.0	20
FCN 10	077409	5.0	8.0	2.5	40
FCN 12	077411	5.0	8.0	2.5	50