

The stainless steel A4 joint for two-shell masonry



BUILDING MATERIALS

- All concrete and masonry materials in conjunction with the appropriate frame fixing.

ADVANTAGES

- The VB securely connects the facing masonry with the load-bearing layer.
- The high quality A4 stainless steel connecting wire guarantees a long-lasting fixing.
- The VB is flexible and can be mounted on any point of the external wall.

APPLICATIONS

- Two skin external walls (facings) acc. DIN 1053
- Straps and economy facings

FUNCTIONING

- The VB must be used with plugs for anchoring in load-bearing walls.
- The frame fixings SXS 10, SXR 10 and FUR 10 have technical approvals for the anchoring of wall ties in concrete, building bricks and perforated sand-lime brick.
- Where the distance between masonry shells is up to 12 cm, 5 wire anchors are to be used per square metre, and where the distance is up to 15 cm, 7 wire anchors. An additional 3 wall ties per metre are to be used along all free edges of the outside shells.
- 5 wall ties per square metre are to be used for mortared closers and economy facings.

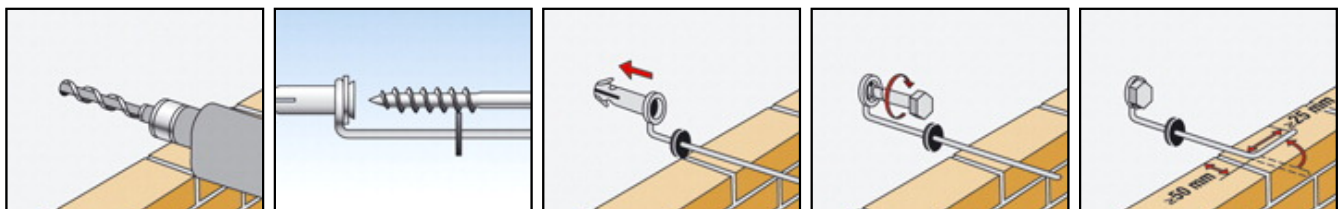

TECHNICAL DATA



Wall tie VB

Article name	Art.-No.	Contents
VB	050495	1 wire anchor, A4 stainless steel, 1 stainless steel washer A4, 1 drip ring